

Settings

This section can be used to update the firmware, customise the Home Page, set the Wi-Fi connection, reset and update your Connected Indoor Unit.

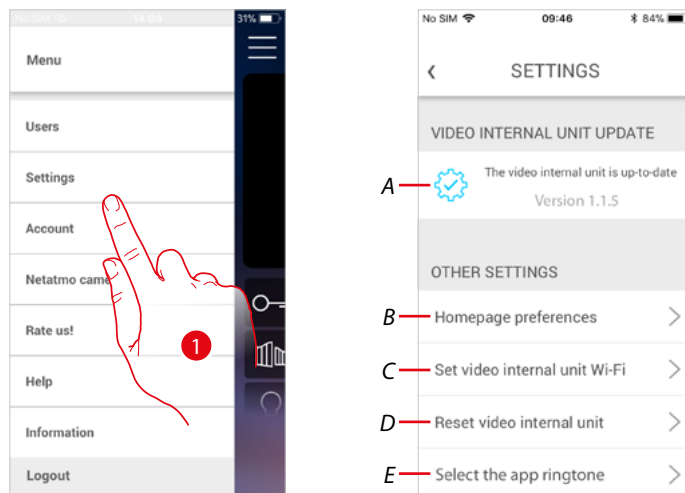

1. Touch to open the setting section.
- A **Update firmware** the Connected Indoor Unit.
- B **Customise the Home page.**
- C Completes the procedure for **setting the Connected Indoor Unit Wi-Fi connection.**
- D Completes the procedure for **resetting Connected Indoor Unit.**
- E Opens the page for the selection of the **ringtones from the App.**